

# TECHNICAL SPECIFICATION - LEVER - LINEAR

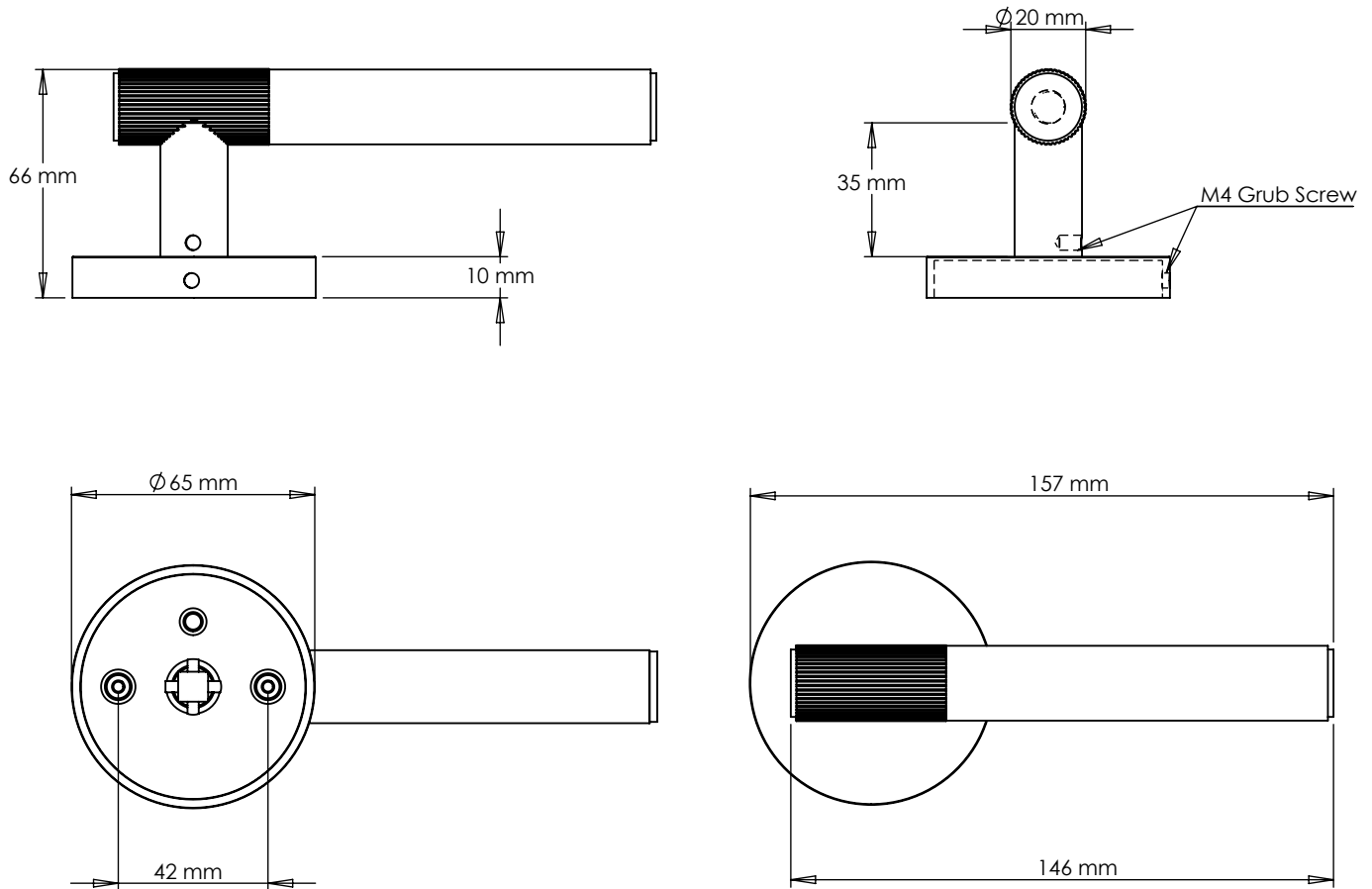

## INCLUDED

1 x pair of sprung door handles  
2 x M4 x35mm through bolts  
1 x 5mm x 5mm x 112mm square spindle  
8 x 4mm woodscrews

## CLEANING & MAINTENANCE

Wipe clean with warm water and a soft cloth. Avoid abrasive towels, sponges, cleaning sprays, bleach and hand sanitizer

## NOTE

Suitable for interior doors only.

Protective lacquer to prevent oxidation and corrosion.

## FINISHES



# PUSHKA HOME